

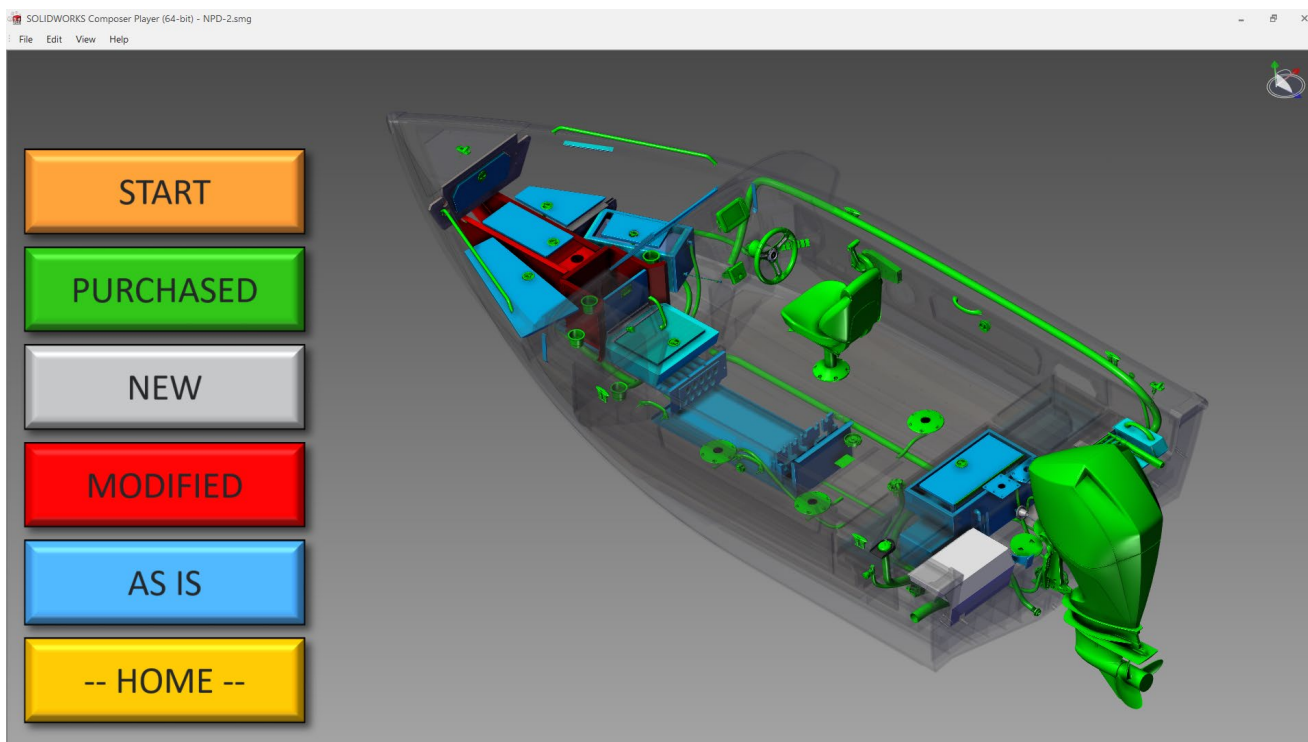

Here is what you saw today...

- Using SOLIDWORKS for new product development while leveraging your existing legacy CAD data quickly, efficiently and *safely*.





Here is what you saw today...

- The SOLIDWORKS ecosystem: multiple products and multiple disciplines all leveraging the same rich 3D CAD data.

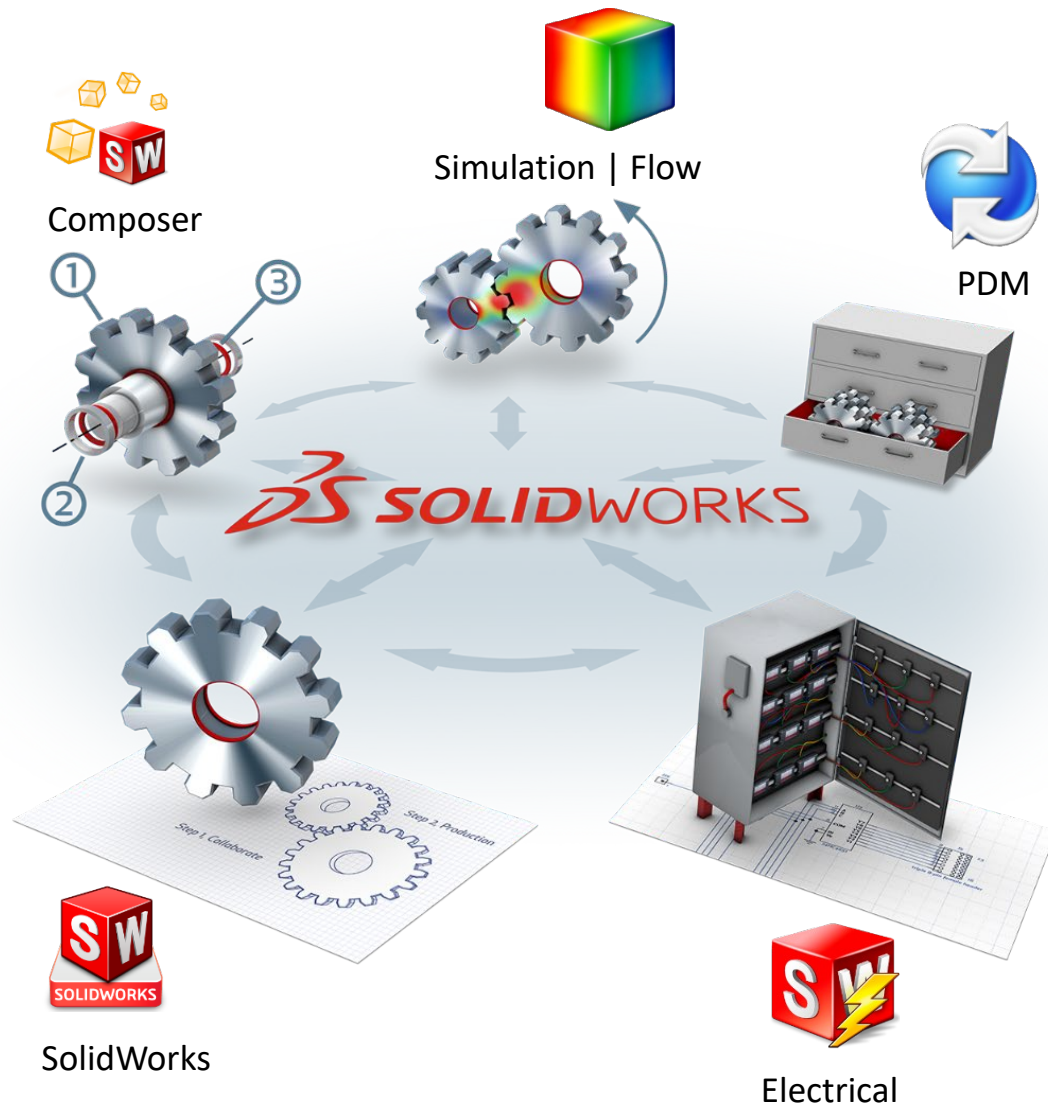



Here is what you saw today...

- SOLIDWORKS PDM tool enabling digital change management and revision control.

The screenshot displays the SOLIDWORKS PDM web interface. At the top, there's a navigation bar with 'File', 'Home', 'Share', and 'View' tabs. Below it, a breadcrumb trail shows the path: 'This PC > OS (C:) > Vault > 03-IV Data > 2XXX'. A search bar is located on the right. The main area is divided into two sections. The top section is a table listing files:

Name	State	Description	Rev	Checked Ou...	Size	Type	Date Modif...	Checked Ou...	Category
2309995.ipt	Approved	SIDE, FMHLDR STRB 1675 REBEL XS	A		974 KB	Autodesk Inv...	01-27-2021...		Files
2309995.SL...	Controlled in Inventor	SIDE, FMHLDR STRB 1675 REBEL XS			251 KB	SOLIDWORK...	03-08-2018...		Files

The bottom section shows a 3D model of a yellow, elongated, tapered part with several holes. To the right of the model is a 'Variable' table:

Variable	Value
Author	WWITT
Cost	
Date	11-08-2017
Description	SIDE, FMHLDR STR...
Design Checker ...	
Document Num...	
Material	Generic
Number	2309995
Part Type	
Project Name	
Project number	1675 REBEL XS
Revision	A
Vendor	
Weight	
Local state	Approved
Local revision	A
Category	Files
Workflow	Inventor Workflow
Local version	2/2

At the bottom left, it says '2 items 1 item selected'.



Here is what you saw today...

- Web client for concurrent design and collaboration with trusted partners, contractors, or anyone in the company who needs to use mobile devices like tablets or cell phones.

The screenshot shows the SOLIDWORKS PDM Web2 - Vault interface. The browser address bar indicates the URL is 'SOLIDWORKS PDM Web2 - Vault'. The page header shows 'SOLIDWORKS | PDM' and 'Vault > Lens Assembly'. Below the header, there are buttons for 'Change State', 'Check Out', 'Download', and 'Delete'. The main content area is a table listing CAD files with columns for Name, Checked Out By, State, Rev, and Description.

Name	Checked Out By	State	Rev	Description
84610429.dwg	mack	<Private State>		
888-111.sldprt	mack	<Private State>		
89-NOAO-4200-0090.SLDASM		Approved	A	LONG BLUE CAM LENS 1 RADIAL PRELOAD ASS
89-NOAO-4200-0091.SLDASM	dean	Approved	A	LONG BLUE CAM LENS 2 RADIAL PRELOAD ASS
89-NOAO-4200-1023.SLDPRT	mack	Approved	A	ELEMENT NO. 1
89-NOAO-4200-1024.SLDPRT		Approved	A	ELEMENT NO. 2
89-NOAO-4200-1057.SLDPRT		Approved	A	BAFFLE, FRONT
89-NOAO-4200-1124.SLDPRT		Approved	A	SPRING MOUNT STUD
89-NOAO-4200-1202.SLDPRT		Approved	A	
89-NOAO-4200-1203.SLDPRT	mack	Approved	A	RADIAL PRELOAD PLUNGER
89-NOAO-4200-1204.SLDDRW	mack	Under E C O	A	
89-NOAO-4200-1204.SLDPRT		Under E C O	A	

Copyright © 1995-2020 Dassault Systemes. SOLIDWORKS PDM Web2 29.1



Here is what you saw today...

- Interactive 3D assembly instructions and process documentation leveraging the existing rich 3D CAD data.

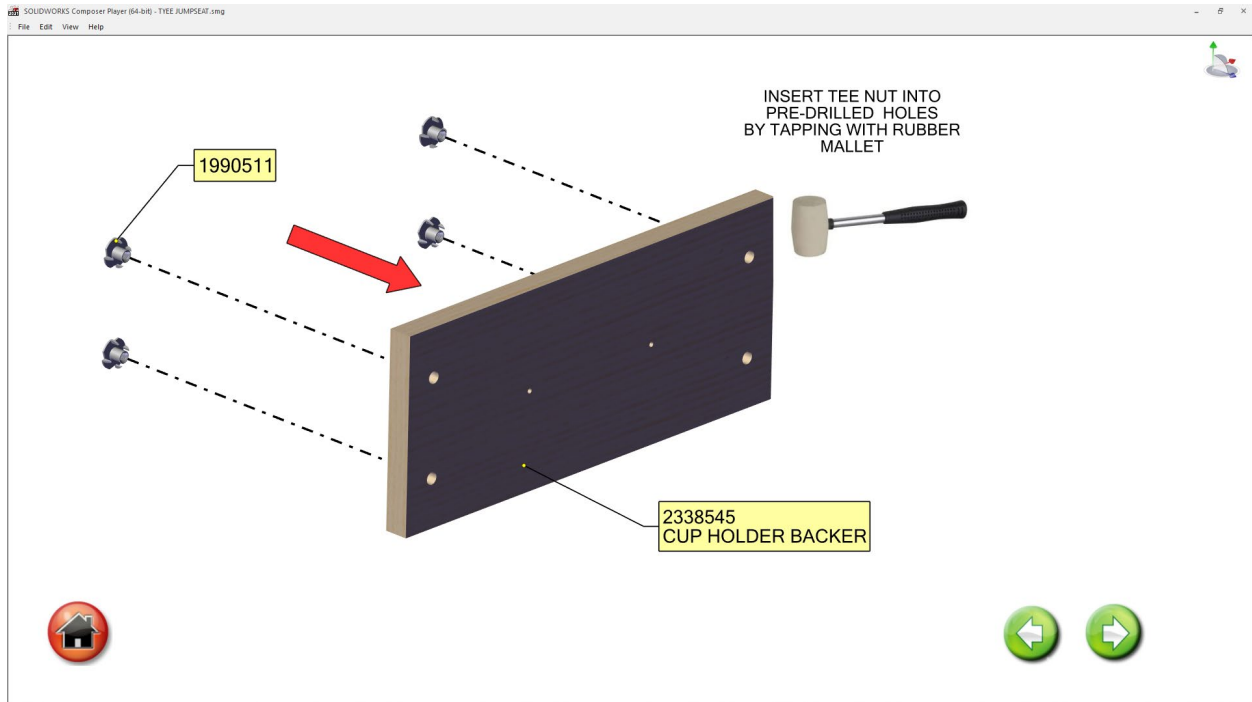



Here is what you saw today...

- Broad range of design validation and CAD-embedded virtual testing capabilities.



SOLIDWORKS SIMULATION

SIMULATION STANDARD

- LINEAR STATIC
- FATIGUE
- MOTION
- TREND TRACKER

SIMULATION PROFESSIONAL

- FREQUENCY
- THERMAL
- EVENT BASED MOTION
- BUCKLING
- TOPOLOGY OPTIMIZATION
- PRESSURE VESSEL

SIMULATION PREMIUM

- DROP TEST
- OPTIMIZATION
- 2-D SIMPLIFICATION
- SUBMODELING
- LOAD CASE MANAGER
- MATERIAL WEB PORTAL

SIMULATION PREMIUM

- NONLINEAR
- MODAL TIME HISTORY
- HARMONIC
- RANDOM VIBRATION
- RESPONSE SPECTRUM
- COMPOSITES



Here is what you saw today...

- Web-compatible technical publications.

SOLIDWORKS Composer Player (64-bit) - PARTS BOOK PAGE-2021.smg

File Edit View Help

BOM ID	Part No.	Description	Qty
1	J-1556	JUMPSEAT HINGE SET	1
2	233267	JUMPSEAT BOTTOM	1
3	2332626	JUMPSEAT PAN LEFT	1
4	2332627	JUMPSEAT SEATBACK	1
5	2332631	BOARD, JUMP SEAT BACK	1
6	2332632	BOARD, JUMP SEAT INSERT	1
7	2336104	JUMPSEAT BACK CUSHION	1
8	P-17625	SQ OVAL TYPE A SS 10-1.00	12



[Gear Box](#)

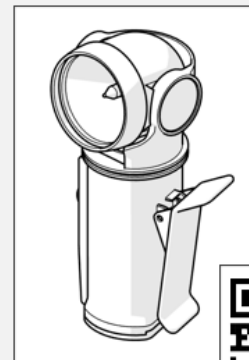

[Flashlight](#)





Want to see this presentation with your organization's data?

Contact us at info@alignex.com or 866-378-6829.

